

Appendix III

Acquisition Information

PR 197
S 19
N.L.C. - 8.

10/26
10/26
W. Beaufort

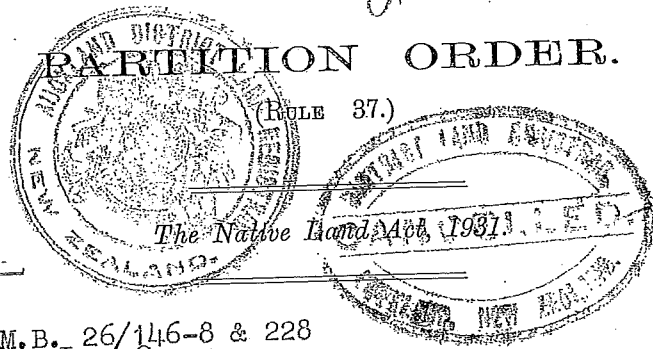

PARTITION ORDER.

(Rule 37.)

No prior title.

Tok. M.B. 26/146-8 & 228
IN THE NATIVE LAND COURT
OF NEW ZEALAND,
Aotea District. } Tauranga Taupo 2B 2M No. 2 Block.

In the matter of the partition of the land known as

Tauranga Taupo 2B 2M Block,

heretofore held under Partition Order
dated the 8th day of March, 1935.

AT a sitting of the Court held at Tokaanu, on the
2nd day of March, 1938, before
James Wakelin Browne, Esquire, Judge.

It is, as a part of the said partition, hereby ordered and declared that

(1) State name, sex, and place of abode.

(1) Ani Miria f.a.
is the owner of that part of the said land, containing 14 acres

named by the Court Tauranga Taupo 2B 2M No. 2 Block,
and which part is particularly delineated in the plan annexed hereto.

As witness the hand of the Judge and the seal of the Court.
FEE CHARGED:

Order 30/- pd.

W. Beaufort
Judge.



*Area now reduced
to 14 ac. by No. 10
No prior title
Area 14 acres
being the block
situated in Blk
IV Tokaanu S.D.
called Tauranga-
Taupo 2B 2M No. 2
Block*

K. 2121 Order in Council, dated 20/2/1918 prohibiting for a period of one year all alienations of the within land other than alienations in favour of the Crown. Entered 10/11/1949 at 10am.

W Benjamin A.B.

K. 2307 Order in Council, dated 19/2/1919, extending K. 2121 for a further period of six months. Entered 10/11/1949 at 10am.

W Benjamin A.B.

K. 2476 Order in Council, dated 25/2/1920 prohibiting for a period of one year all alienations of the within land other than alienations in favour of the Crown. Entered 10/11/1949 at 10am.

W Benjamin A.B.

K. 2872 Order in Council, dated 1/2/1921, extending K. 2476 for a further period of six months. Entered 10/11/1949 at 10am.

W Benjamin A.B.

K. 2978 Order in Council, dated 25/7/1921, extending K. 2476 for a further period of eighteen months. Entered 10/11/1949 at 10am.

W Benjamin A.B.

K. 3597 Order in Council, dated 9/3/1923 prohibiting for a period of one year all alienations of the within land other than alienations in favour of the Crown. Entered 10/11/1949 at 10am.

W Benjamin A.B.

K. 4010 Order in Council, dated 4/3/1924 extending K. 3597 for a further period of six months. Entered 10/11/1949 at 10am.

W Benjamin A.B.

K. 4218 Order in Council, dated 19/1/1924 extending K. 3597 for a further period of eighteen months. Entered 10/11/1949 at 10am.

W Benjamin A.B.

K. 6461 Order in Council, dated 15/3/1926 prohibiting for a period of one year all alienations of the within land other than alienations in favour of the Crown. Entered 10/11/1949 at 10am.

W Benjamin A.B.

K. 7312 Order in Council, dated 21/2/1927 extending K. 6461 for a further period of six months. Entered 10/11/1949 at 10am.

W Benjamin A.B.

K. 7819 Order in Council, dated 3/5/1927, extending K. 6461 for a further period of eighteen months. Entered 10/11/1949 at 10am.

W Benjamin A.B.

K. 9951 Order in Council, dated 3/4/1929 prohibiting for a period of one year all alienations of the within land other than alienations in favour of the Crown. Entered 10/11/1949 at 10am.

W Benjamin A.B.

K. 11417 Order in Council, dated 26/3/1930 extending K. 9951 for a further period of six months. Entered 10/11/1949 at 10am.

W Benjamin A.B.

K. 11990 Order in Council, dated 22/9/1930 extending K. 9951 for a further period of six months. Entered 10/11/1949 at 10am.

Memorandum

The DISTRICT

AUCKLAND

Re _____ I

HEREWITH I forward the attached form.

Part _____

Solicitors acting:

Messrs. _____

Bal _____

T

CONTINUED BACK OF PLAN SHEET

K. 24595 Act to the reservation of a public right of way
over a strip of land around the margin of Lake Taupo
see Section 14 of the Act of 1926. No. 64. *M Benjamin*
A.L.R.

No. 10407 Proclamation taking 3 acres for a Maori School,
Entered 10/11/1949 at 10 am. *M Benjamin*
A.L.R.

Cancelled and Certificate of Title issued
see Vol: 976 Fol: 102 C.R.D. *unbridge*
A. L. R.

17: 11: 1949

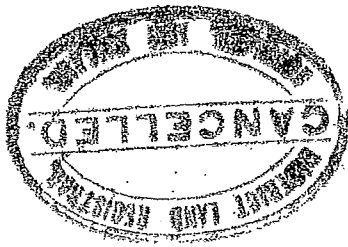

Waikato M

by
th
de
Crc
affe

it of
(sub
to th

as the

(being

of free
hereto
or in
or shall
And
hereby de
directed t
day of
As wi

CHARGED

27 ATK 149

920

The Native Land Act, 1931.

Tok. M.N. 27/149
IN THE NATIVE LAND COURT,
NEW ZEALAND,
Aotearoa DISTRICT.

In the matter of the land known as

Tauranga-Taupo 2B24 No. 2

At a sitting of the Court held at Tokaanu on the
24th day of September, 1941, before
Robert Freshwater Dykes, Esquire, Judge:

WHEREAS portions of the Tauranga-Taupo 2B24 No. 2
Block have been taken under the Public Works Act, 1928, for the
purposes of a school, by Proclamation
dated the 29th day of August, 1940, and
in pursuance of the authority conferred upon
The Assistant Under-Secretary, Public Works Department
has made application to the Court to assess the amount of compensation to
be paid to the owners and other persons interested in the said land and to
decide who are the proper persons to receive such compensation so assessed:

Upon hearing the parties, and evidence taken, it is hereby ordered as
follows:—

That the amount of compensation which ought to be paid for the
land so taken as aforesaid is the sum of £140.0.0 with interest @ 5%
for 1 year
such sum to be paid to the Aotearoa District Māori Land Board
on behalf of Aui Hia, sole owner of the above-mentioned block.

As witness the hand of the Judge and the seal of the Court.



R. Dykes
Judge.

24

with *atgalipapu* *Iuranga* as trustee for the ~~trust~~ ^{trust} *Iura* and *Iumatangana* and *cbahurika* will have as trustee *cbahanariki* to *Waru*.

Ordered accordingly

Appⁿ 47

Appⁿ for assessment of compensation for an area of 23 ac. 1 ro. 3 l per. taken from *Puketapu* 3^B ctⁿ 7 Block for the purposes of a Quarry. The land is situated in Block I *cbamgaku* *burvey* District. Gaz. taking is dated 11 Jan. 1940 at page 2. Land is subject to Part I/1930 but no work has been done on the Block. see next page. Hand in special government valuation. Valuation shows £30.

cl^w vice for P.W. to

cl^w Asher. Appⁿ 48

Appⁿ for application to stand over till 2 pm. (to stand over, Appⁿ for assessment of compensation for land taken for the purposes of a *Pumie Pit* in Block III *cbamanii* *burvey* District. Part *Wharetoto* ctⁿ 9 Block Area 3 ac. 1 ro. 5 perches - (see next page.)

cl^w vice

Put in the Valuation. A special Valuation to stand over

Appⁿ 49 X

Appⁿ for assessment of compensation for land taken for the purposes of a school in Block IV *Tokaanu* ctⁿ 10. Area 3 acres. part *Iauranga* *Iaupō* 2^B 2^M Block. Gaz. ctⁿ 91 29 August 1940. p. 2232.

cl^w vice

Land taken by agreement and the P.W. Act used for convenience. The Crown agreeing with the owner to pay the sum of \$140 for three acres. And *cbona* the owner donating one acre and the Crown paying for two acres at the rate of \$70 per acre.

cl^w Suckson Court.

the owner. The agreement is correct. Ordered accordingly. Compensation money payable to the *Board* with interest at 5% for one year. Amount \$140.

Appⁿ 142 X

Successⁿ to interest of *cbri* to *Rauparaha* decd. in *Wahi Kahakaha* 4^B Block.

cl^w Asher

I refer the Court to *cl^w B.* 26/150. where evidence given

All correspondence should be addressed to:
The Regional Superintendent,
Department of Education,
Private Bag, Newmarket,
Auckland.



Form E. 7 '14

Office Address:
"Gillies Avenue,
Newmarket,
Auckland."

Telegraphic Address:
"Schools" Newmarket.
TELEPHONE 53 099

DEPARTMENT OF EDUCATION
NEWMARKET, AUCKLAND.

| | |
|---|-----------|
| In reply please quote: | E. 44/4 |
| If calling on this matter please ask for: | Mr Andrew |

15 July 1969

The District Commissioner of Works,
Ministry of Works,
Private Bag,
HAMILTON.

TAURANGA-TAUPO MAORI SCHOOL
TRANSFER TO EDUCATION BOARD CONTROL

By Proclamation in N.Z.Gazette No.91 of 29 August 1940 at page 2232 an area of 3 acres described as being portion of Tauranga Taupo 2B2M Block, Block IV Tokaanu S.D. was taken for a Native school. S.O. Plan 30764.

Compensation in the sum of £140 plus £7 interest was awarded to the vendor, Ani Miria (Mrs Ereckson) by the Native Land Court sitting at Tokaanu on 24 September 1941.

New Zealand Gazette No.46 of 4 August 1966 at page 1234 records the setting apart of 1 acre and 20 perches of Crown Land as an addition to the school site. S.O.Plan 42907. This additional land, described as Part Tauranga-Taupo 2B2M 3B 3B Block IV Tokaanu S.D., was acquired by Lands Department from Maori owners at a cost of £5,250.

Lands and Survey Department's file reference in connection with this latter purchase is M.P.48. Your reference is 37/13/0 report of 6 November 1964.

Andrew

J. H. ANDREW
for Regional Superintendent of
Education

30
Legal
state prim. change to school.

J. 22/8/69

[Signature]

Proc to H.O 26.7.69
-file 39/0.

3/1

Embodied in the Provisional Register this

2nd day of March 1965
at 10.55 a.m. *De Jure* A.L.R.

[N.L.C.—7.]

PARTITION ORDER

(RULE 37.)



256/19

Tekranu M.B. 57 / 918-118

The Native Land Act, 1931.

IN THE NATIVE LAND COURT,
NEW ZEALAND.
Aotearoa DISTRICT.

Tauranga Taupo 2B 2E 5E No. 3B

In the matter of the partition of the land known as

Tauranga Taupo 2B 2E 5E No. 3 heretofore held
under Partition Order, dated the 15th day
of March, 1942

AT a sitting of the Court held at Tekranu
on the 20th day of March, 1942
before Robert Lawson Duke Esquire, Judge.

It is, as part of the said partition, hereby ordered and declared that the
several persons whose names appear in the first column of the schedule endorsed
hereon or annexed hereto, and therein numbered from one to twenty-two
both inclusive, are the owners, in the relative shares or proportions set out
in the second column of the said schedule, of that part of the said land,
containing ^A 7-1-34 ^{PP} 34- named by the Court

Tauranga Taupo 2B 2E 5E No. 3B

and which part is particularly delineated in the plan attached hereto.

FEES CHARGED: As witness the hand of the Judge and the seal of the Court.

Order fee: 30/- pd

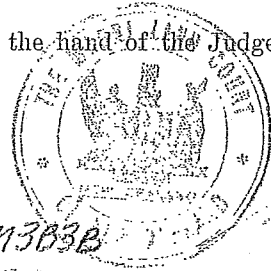

Notitle
Tauranga Taupo 2B 2E 5E No. 3B
Area: 7-1-34
Blk. IV. Tekranu S.A.
Legal access.
19.2.65.

Judge.

~~Responsible of said money charges
7.17.6~~

1/1002

THE SCHEDULE WITHIN REFERRED TO.

| FIRST COLUMN. | | | SECOND COLUMN. |
|---------------------|------------------------|-------------------------|--------------------|
| No. | Name. | Sex and (if Minor) Age. | Relative Interest. |
| 1. | Te Hehe te Hehe | m.a. | 3 |
| 2. | Neoni te Hehe | m.a. | 7. 3 |
| 3. | Putita Mopuke | f.a. | 3. 571 |
| 4. | Yerani te Hehe | f.a. | 7. 3 23.24 |
| 5. | Mitereta te Hehe | f.a. | 7. 3 |
| 6. | Hehienga te Hehe | m.a. | 3. 4 |
| 7. | Hehuia Wanea | f.a. | 30. |
| 8. | Peteriki Tupa | m.a. | 30. |
| 9. | Nine te Hehe | m.a. | 3. 4 |
| 10. | Rangiriri te Hehe | f.a. | 7. 3 |
| 11. | Rangitira te Hehe | m.a. | 31. |
| 12. | Riki te Hehe | f.a. | 7. 5 |
| 13. | Reere Hehe | m.a. | 4. 110 |
| 14. | Rongomairihiti te Hehe | m.a. | 3. 4 |
| 15. | Tiuku te Hehe | m.a. | 4. 3 |
| 16. | Tukorehu Tukorehu | m.a. | 3. 555 |
| 17. | Tupu Paunini | m.a. | 10. |
| 18. | Te Hira te Hehe | f.a. | 7. 5 |
| 19. | Heurhikihiki te Hehe | f.a. | 6. 607 |
| 20. | Te Waka Matanga | m.a. | 4. |
| 21. | Wairemano Hehe | m.a. | 4. 3 |
| 22. | Waratapu Hehe | f.a. | 417 |
| <u>TOTAL SHARES</u> | | | 201. 204 |

South Auckland Land District

IV Tokaanu S. D.

Lake Taupo

One chain width R.O.W. along lake edge. See Statutes 1926 No 64 Sec. 19(3)

Pt. 2B2M2
Maori
School

Public Road. Sec. 96 M.L.C. Act 1886

National Park - Taupo S.H.

2B2M3B3B

7. 1. 34

1340.4

490.35

3B3A1

267.05

7. 1. 34
1. . . . 20
6. - 1 - 14

Gen. Robt. ...

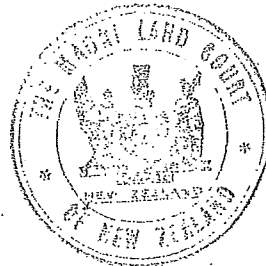

Tauranga - Taupo 2B2M ~~See~~ 3B3B

M.L. 17862

Book 4. Clerk to the Court.
C. A. LAWN, Chief Surveyor.
A. SANDEL, Surveyor.

PR. 256/9

256/9

S 307161 Trustee order vesting
the within land in Hepi
te Heuhea, Pateriki Hura,
Bison Jones, Maisehana
Tamaisa, Wasatana Ngahana,
Hond Iwa Mese Hauauru
Tupu - produced
2-3-1965 at 10.56.00

Subject to section 438 ^{Proffores} ALR
Land Transfer Act 1953 ^{Proffores}
* ALR

* S 396817 ONCT } cancelled and
7.2.1968 } G.J. 8A/1061
issued ^{Proffores}
ALR

* S 314630 Proclamation declaring
part of the within land (1 acre 20 perches)
to be Crown land. produced
2.6.1965 at 9.05.00 ^{Proffores}
ALR

256/9

| | |
|--------------------------|-------|
| LAND & DEEDS | |
| Nature: | P/R. |
| GMPKINS, WAKE & PATERSON | |
| 2 MAR 1965 | |
| Time: | 10.55 |
| Fee: £ | 1 |
| Abstract No. | |

Ministry of Works,
Private Bag,
HAMILTON.

6 November 1964

The District Commissioner of Works,
HAMILTON.

RAIRAKIA-TAIRO HAKAI SCHOOL

Lands Department has arranged the acquisition of an area of land as an addition to this school details being as under. Lands Department will complete the acquisition from the Maori owners but before proceeding further, wishes to have an assurance that the proposal has financial approval.

AUTHORITY: Education Department Auckland 44/4 of 14 October 1964.

LAND: Pt Tauranga Taupo 2224 33 10 Block IV Tokaona R. D. area 1a. Or. 20y. as shown edged red on the attached print.

STATUS: Maori land.

PURCHASE PRICE: \$4250

VALUATION: Government special 6/5t C.V. 45250 U.V. 45250

COMMENTS: This is an area of mainly flat land at road level between the main road and the lake on the north side of the school. It is part of a block which the owners have schemed for subdivision and which could be expected to sell readily at good prices.

The portion being purchased is in effect six sections but some adjustment is necessary to shift an access way which was schemed on the north side of the School property to the north of the area being acquired. This is illustrated by the print.

I consider the price very reasonable and I understand from Lands Department that this is because the owners wish to raise some ready money for development.

RECOMMENDATION: I recommend approval to purchase at \$4250 subject to any adjustments.

VOUCHER CERTIFIED

[Signature]

DATE 19-365

[Signature]
(J. S. Weston)
Land Purchase Officer

[Signature]
(C. H. Curdley)
District Land Purchase Officer

The Commissioner of Works

I concur.

Assistant Chief Land Purchase Officer

(B)

MEMORANDUM OF TRANSFER

W H E R E A S HEPI TE HEUHEU

PATERIKI HURA

(1) BRIAN JONES

WAIREMANA TAMAIRA

WARATANA NGAHANA

and IWA MERE HAUAUURA TUFU

, being registered as the proprietor of an estate⁽²⁾

being the trustees appointed as hereinafter set out and being registered as the proprietors of an estate in fee simple

subject, however, to such encumbrances, liens, and interests as are notified by memoranda

written or endorsed hereon, in all that piece of land situate in the⁽³⁾ Block V Tokaamu Survey

District in the Land District of South Auckland

⁽⁴⁾ Here state area.

containing⁽⁴⁾ Seven acres one rood and thirty-four perches (7 - 1 - 34)

⁽⁵⁾ Here set out the land as described in the relative Certificate of Title and refer to the title by its volume and folio, and in cases other than "fee-simple" also refer to the document being dealt with by number and description, stating whether the land is the whole, the balance, or only a part of that in the title and/or document.

be the same a little more or less,⁽⁵⁾ being the block of land known as Tauranga Taupo 2B2M3B3B and being all the land contained and described in a partition order of the Maori Land Court dated the 25th day of March, 1942 and recorded in Tokaamu Minute Book 27 Folios 218 and 219 AND WHEREAS at a meeting of assembled owners of the said land duly summoned under the provisions of Part XXIII of the Maori Affairs Act 1953 on the 3rd day of October, 1964 it was resolved that the part of the said piece of land containing one acre and twenty perches (1 - 0 - 20) as shown by the diagram endorsed hereon and therein bordered red and also as shown and described as Part Tauranga Taupo 2B2M3B3B on S.O. Plan numbered 42907 be sold to HER MAJESTY THE QUEEN for the sum of Five thousand two hundred and fifty pounds (£5250.0.0) AND WHEREAS the assembled owners at the aforesaid meeting duly passed and adopted a resolution vesting the aforesaid land in the aforesaid trustees with power to subdivide and effect sales of the whole or any part of the aforesaid land AND WHEREAS on the 23rd day of October, 1964, the Maori Land Court did, acting under the provisions of Section 438 of the Maori Affairs Act 1953, duly confirm the resolution establishing the trust AND WHEREAS the Minister of Maori Affairs, acting under the provisions of the said Section of the said Act did, on the 10th day of November, 1964, approve of the establishment of the said trust NOW THEREFORE IN CONSIDERATION of the sum of Five thousand two hundred and fifty pounds (£5250.0.0) paid to the aforesaid trustees by HER MAJESTY THE QUEEN (the receipt of which sum is hereby acknowledged) the aforesaid trustees DO HEREBY TRANSFER to HER MAJESTY THE QUEEN, for the purposes of the Public Works Act 1928, all the estates and interests of the owners in the said land.

SIGNED severally by each of the persons whose names are written in the first column and are signed in the second column of the Schedule hereto before us the attesting witnesses whose signatures are set forth in the third column of the Schedule hereto opposite the names of the persons whose signatures we attest AND WE HEREBY CERTIFY that the same was signed on the dates set forth in the Fourth column of the said Schedule opposite such signature.

- SCHEDULE -

| (1) Name of Maori | (2) Signature of Maori | (3) Signature of Witness | (4) Date |
|------------------------|-------------------------------|-------------------------------|-------------|
| HEPI TE HEUHEU | <i>Hepi Te Heuheu</i> | <i>Witness to all</i> | 10. 2. 65 |
| PATERIKI HURA | <i>Pateriki Hura</i> | <i>the signatures</i> | 10. 2. 65 |
| BRIAN JONES | <i>Brian Jones</i> | <i>Henry Hudson</i> | 10. 2. 65 |
| WAIREMANA TAMAIRA | <i>W. Tamaira</i> | <i>Schuster</i> | 10. 2. 65 |
| WARATANA NGAHANA | <i>W. NGAHANA</i> | <i>W. NGAHANA</i> | 10. 2. 65 |
| IWA MERE HAUAUURA TUFU | <i>Iwa Mere Hauauura Tufu</i> | <i>Iwa Mere Hauauura Tufu</i> | 10. 2. 65 |

South Auckland Land District.

Blk IV Tokaanu S.D.

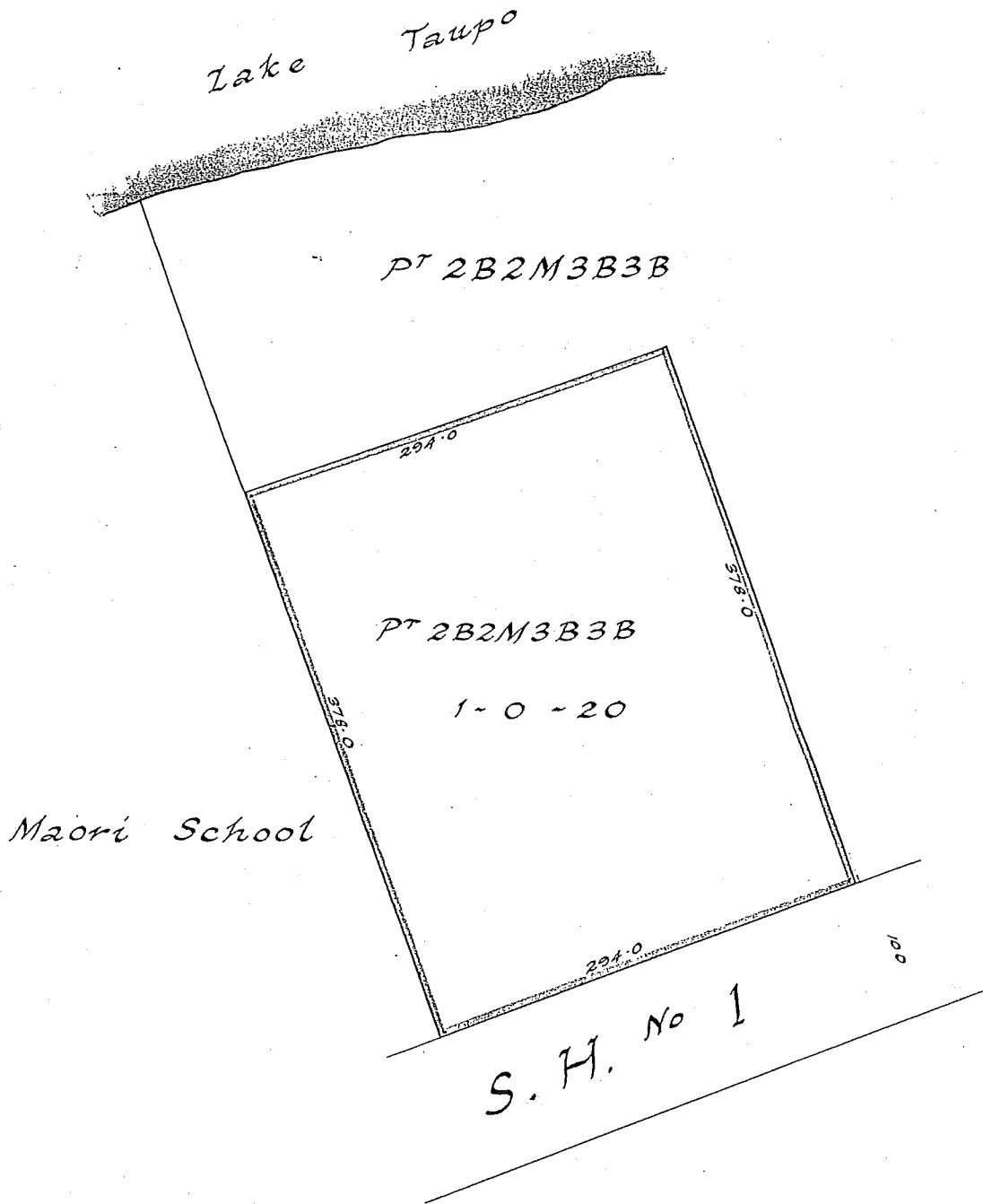

PT Tauranga Taupo 2B2M3B3B

Scale = 80 links to an inch.

Delt = C. Joseph. 17-12-



Department of Lands & Survey

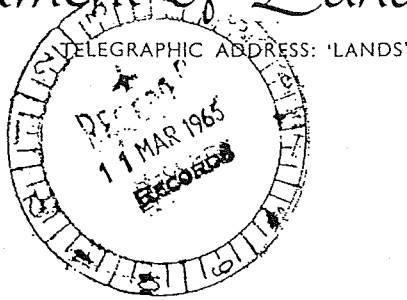

TELEPHONE No. 81 189
OUR REFERENCE: M.P. 48
YOUR REFERENCE:

DISTRICT OFFICE.
P.O. BOX 460,
HAMILTON.

3 March 1965.

The District Commissioner of Works,
Ministry of Works,
Private Bag,
HAMILTON.

ADDITION TO TAURANGA - TAUPO SCHOOL PT TAURANGA
TAUPO 2B2M3B3B BLOCK -

Your Ref : 37/13/0

The survey of the 1 - 0 - 20 area purchased from the Maori owners has now been completed and the plan numbered S.O. 42907.

A memorandum of Transfer in duplicate has been signed by the trustees together with an authority for the purchase monies £5,250 to be paid to their Solicitors - Messrs Hadfield, Peacock and Tripe of Wellington.

I am forwarding herewith one copy of the Memo of Transfer together with the authority by the trustee's so that you may arrange payment accordingly.

This memorandum of Transfer will not be registered with the District Land Registrar but will be lodged with the Crown Purchase Deed Series in the Head Office of this Department and a Proclamation under Section 255/1953 Maori Affairs Act will issue to declare the Land Crown Land and extinguish any existing titles. Following this action the land will be set apart for education purposes.

D.B. HOPCROFT.
Chief Surveyor.

Per: *[Signature]*

Encl:

Register :

Legal
Andrew Schoff
See
Warrant 1940/2232
at 20/1/65

VOUCHER CERTIFIED
[Signature]
DATE 19-3-65

f

WORK-AUTHORITY REQUISITION

To ~~Commissioner of Works~~
 *District Commissioner of Works
 *Resident Engineer

Applicant's Reference No. 44/4

Ministry of Works File Reference: 37/13/0

Ministry of Works

Department: Education

Private Bag, HAMILTON.

Place: Newmarket

(Place)

Date: 20 November 1964

*Strike out words not applicable.

Please ~~arrange~~ the following work at an estimated cost of £ 5,250 - -

Reference to estimate; Date supplied 6/11/1964 by District Commissioner of Works, Hamilton

(For instructions for use—see back)

TAURANGA-TAUPO MAORI SCHOOL : ADDITIONAL LAND

Under Ministerial authority 7327, £5,250 has been approved for the acquisition of portion Tauranga Taupo 2B2M 3B 3B Block IV Tokaanu Survey District, area 1 acre 0 roads 20 perches. The land is Maori owned.

| State of Vote/Item/Authority as at..... | | Vote/Item | Authority |
|---|-------|-----------|-----------|
| Appropriated | | | — |
| Authorised | | | |
| pending to | % % | | |
| Balance | | | |
| Less commitments | | — | |
| Authority available | | — | |

Nature of approval/~~Ministerial~~ ~~Ministerial~~ ~~Ministerial~~ Ministerial.
 (Strike out words not applicable). ~~Ministerial~~

Accommodation Board Approval: ~~Not applicable~~ ~~Not applicable~~ Not applicable.

Vote to which work is ultimately to be charged: Education Buildings

Authorising Officer: C. Alison

Designation: for Actg Superintendent of Education

FOR MINISTRY OF WORKS USE ONLY

To

Recommended £

 / /

Approved £

 / /

Authorised Approving Officer.

 / /

Ministry of Works,
 HAMILTON

15 DEC 64

ASm.

£ 5,250-00 has been approved for expenditure on the work specified above.

R. D. SANDFORD
 Issuing Officer.

Code No. 178/358070.

39/302/0

65-099

=====
Private Bag,
HAMILTON.

16 February 1970

The County Clerk,
Taupo County Council,
P.O. Box 128,
TAUPO.

Dear Sir,

TAURANGA - TAUPO PRIMARY SCHOOL

I am advised by the Education authorities that the Maori owners of the land adjoining the Tauranga - Taupo primary school have carried out a subdivision which amongst other things provides for the preservation of an area between the school and the lake for addition to the school site. I have obtained a copy of plan S.12494 which shows an area of 30.3 perches as Lot 1. Could you please let me have details of the arrangements with regard to this piece of land ~~given~~^{made} when the subdivision was approved.

Is it correct that the land is to be added to the school site and if so is any action by us required to give effect to the arrangements.

Yours faithfully,
R.E. Hermans
District Commissioner of Works

Per:



(J.D. Walton)

TAUPO COUNTY COUNCIL

SUB OFFICES:
MANGAKIN
BOX 9
TELEPHC 432
TURANGI
BOX 34
TELEPHONE 8449

72 LAKE TERRACE, TAUPO
PRIVATE BAG, TAUPO

TELEPHONES 119
394



L 3/253

OUR REFERENCE: _____

YOUR REFERENCE: _____

18 February 1970

The District Commissioner of Works
Private Bag
HAMILTON

Dear Sir,

Town of Oruatua Extension No.25
Tauranga-Taupo Primary School

I acknowledge your letter 39/302/0 of the 16 February and advise that the approval of the scheme of subdivision was conditional upon the amalgamation of Lot 1 with the adjacent Maori school or the adjacent esplanade reserve. The option was left with the owner and we understand his intention was to amalgamate the said Lot with the school. At the time it was checked with the D.L.R. and we understand that he would not issue a separate title for this individual lot as it had no road frontage.

We do not know of any arrangements as to purchase price, if any.

Yours faithfully,

G. B. BURTON
County Engineer

(Job no 01970/139)

L 170

JDW:MCV

39/302/0

65-099

=====
Private Bag,
HAMILTON.

24 February 1970

The Commissioner of Works,

TAURANGA - TAUPO SCHOOL

Your reference is 31/1031/1 and I refer to your minuted copy of a letter from Tripe Matthews and Feist regarding the addition to the school site.

I should be obliged if you will let me have the origin of your information when you say to the Director General of Education that no payment is involved.

I have been in communication with the Taupo County Council who advise that while the scheme of subdivision was conditional upon the amalgamation of this lot either with the school or the adjacent reserve no stipulation was made as to purchase price or free vesting.

R.E. Hermans
District Commissioner of Works

Per:

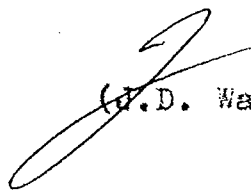
(J.D. Walton)

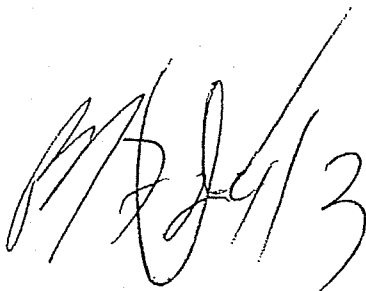

The Commissioner of Works,

The attached Declaration declaring additional land taken for a State Primary school in Block IV, Tokaanu Survey District, Taupo County, pursuant to section 32 of the Public Works Act 1928, has been prepared at the instance of the Department of Education, and refers to the Tauranga - Taupo Primary School.

The Maori owners of the land are subdividing their adjoining land. The Taupo County Council approved of the subdivision subject to the addition of the land described in the Declaration either to the school site or to an adjacent esplanade reserve. The owners have requested, through their solicitors, that the land be taken and added to the school site. There is no monetary consideration.

The Declaration is recommended for signature.

R.E. Hermans
Dist Commr of Works

Per: 

16 JUN 1970

Hon. Minister of Works,

Recommended for approval. ONE signature is required please.

F.R. Askin
Commissioner of Works

Per:

I certify that the attached document is in order for signature.





65-099

xxxxxx

Private Bag,
HAMILTON.

15 June 1970

Messrs Tripe, Matthews & Feist,
Solicitors,
P.O. Box 5003,
WELLINGTON, 1.

Dear Sirs,

TAURANGA - TAUPO PRIMARY SCHOOL

I regret the delay in replying to your letter of 16 April 1970 addressed to the District Commissioner of Works, Wellington, which has been referred to me.

A Declaration taking an area of 30.3 perches being Lot 1, L.T.S. 12494 has been submitted to my Head Office for signature. Provided my Head Office is satisfied, in terms of section 32 (4) of the Public Works Act 1928, that there is a sufficient agreement to take the land, the Declaration will be recommended for the Minister's signature and gazetted in due course.

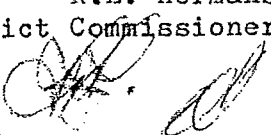
Yours faithfully
R.E. Hermans
District Commissioner of Works
Per: 
(P.A. Penfold)

The Commissioner of Works,

Your minute P.W. 31/1031/1 of 24 April 1970 refers.

I enclose:

- (a) Declaration (in duplicate)
- (b) Quarter sheet (in duplicate)
- (c) Search No.45 of 5.3.70 and search copy of C.T. 8A/1061

GAZETTED 19.70 PAGE 1280

If you consider the Declaration is in order for signature, please let me have 10 Gazette extracts in due course.

To be checked
Job No G1970/139
17/6/70

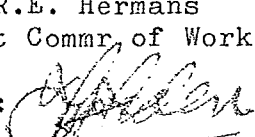
R.E. Hermans
Dist Commr of Works
Per: 
(T.N. Foden)

16 JUN 1970

Encl

Per
B/O
19/6/70
cl

NR E501 HO HM 17.6.70 PW31/1031/1

TAURANGA TAUPO SCHOOL

YOUR FILE 39/302/0

ATTN: LEGAL AND LAND

TRIBE MATTHEWS AND FEIST WRITE FOR URGENT ACTION REQUESTING THAT LOT 1 ~~OK~~ LT PLAN 12494 SOUTH AUCKLAND REGISTRY BE TAKEN FOR SCHOOL.

I UNDERSTAND AREA 15.20 ~~PERCHES~~ PERCHES.

NO MONEY INVOLVED.

PLAN APPROVED ONLY ~~XXXX~~ SUBJECT TO THIS LAND BEING ADDED TO SCHOOL OR MADE RESERVE. OWNERS WANT IT ADDED TO SCHOOL URGENTLY AS SALE OF OTHER BOND HELD UP UNTIL THIS IS DONE.

PLEASE SEND TAKING DECLARATION.

Mr Brown,
You need to please
refer to 45 of
area of lot 1, L.T.S 12494.
17/6

F R ASKIN
PER C STUBBS
1430 RW

D114

HM HO

17.6.70

39/302/0

TAURANGA TAUPO SCHOOL

YOUR REF E 501



OF 17.6.70

FILE PW 31/103/1

ATTN MR STUBBS

DECLARATION TAKING LOT 1, L.T. PLAN S. 12494 WAS SENT
TO YOU YESTERDAY WITH THE REQUEST THAT YOU ARRANGE GAZETTING
IF YOU CONSIDER THERE IS A SUFFICIENT AGREEMENT.

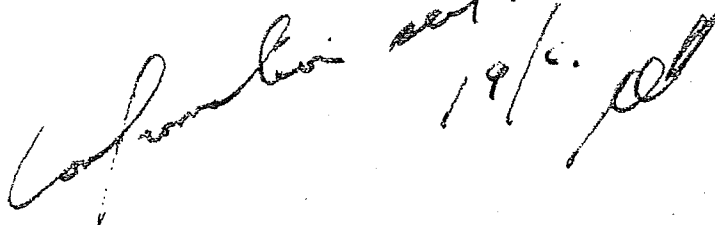
ACCORDING TO OUR SEARCH NOTES, WHICH I SHALL HAVE
CHECKED, THE AREA IS 30.3 PERCHES.

Confidential ref. 19/6.70



R E HERMANS

PER P A PENFOLD

1531

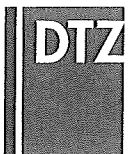
BW 



Appendix II

Search Copies

NEW ZEALAND REGISTER

REGISTER

Form B.

Register-book.

Vol. 976, folio 108

976/108

P.R. Vol. 197, Folio 19
Transfer No.
Application No.
Order for N/C No.



PART CANCELLED

CERTIFICATE OF TITLE UNDER LAND TRANSFER ACT

This Certificate, dated the seventeenth day of November, one thousand nine hundred and forty-nine under the hand and seal of the District Land Registrar of the Land Registration District of AUCKLAND, witnesseth that ANI MIRIA f.o. a Maori,

is seized of an estate in fee-simple (subject to such reservations, restrictions, encumbrances, liens, and interests as are notified by memorial under written or endorsed hereon, subject also to any existing right of the Crown to take and lay off roads under the provisions of any Act of the General Assembly of New Zealand) in the land hereinafter described, as the same is delineated by the plan hereon bordered green, be the several admeasurements a little more or less, that is to say: All that parcel of land containing fourteen acres more or less situated in Block IV Tokaamu Survey District being the Block called Tauranga Taupo 2B 2M 2.

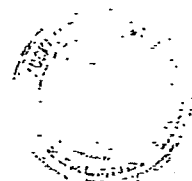
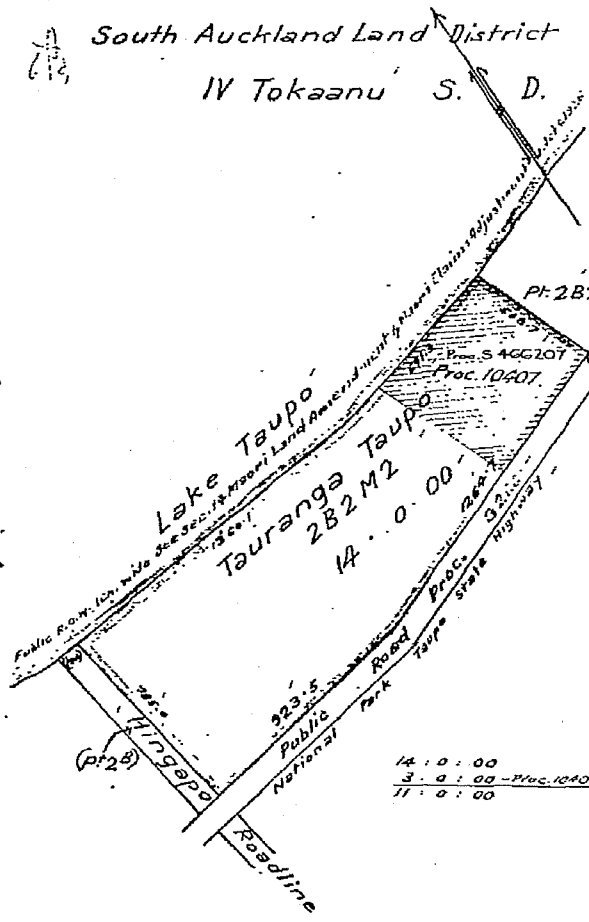

C.R. Sautridge

Assistant District Land Registrar.

X.24595 As to the reservation of a public right of way over a strip of land around the margin of Lake Taupo see Section 14 of the Acts of 1926 No. 64.

C.R. Sautridge A. L. R. No. 10407 Proclamation taking 3 acres for a Maori School. Entered 10/11/1949 at 10a.m.

C.R. Sautridge A. L. R. S. 9820 1/2 s.e. of lot 1 plan 37294 Rai Mita to Lewis Guitara produced 11/2/1950 at 11.05 a.m. 983/271

S. 9829 1/2 s.e. of lot 2 plan 37294 Rai Mita to Lewis Guitara produced 11/2/1950 at 11.6 a.m. 983/273

O. 412768 Partition Order vesting Tauranga Taupo 2B2M2 in Ani Mita produced 27.1.1968 at 9.40 a.m. 9C/92

Sub 207: Gazette Notice declaring part 6 within (3 acres) taken by Proclamation 10407 set apart for State primary schools entered 18.11.1969 at 2.00 p.m.

A.L.R.

THIS CERTIFICATE (ON A REDUCED SCALE) IS DEEMED TO BE A TRUE COPY OF THE ORIGINAL REGISTER FOR THE PURPOSES OF SECTION 225A LAND TRANSFER ACT 1952.

Scale: 8" = 1 chain to an inch. F.S. R.O.C. ... Compiled: N. Price, Draftsman.

S. 539224 Partition Order vesting Tauranga Taupo 2B2M2A in Raukawa Maniapoto produced 16.11.1971 at 9.00 a.m. C.T. 130/535

A.L.R.

[Extract from N.Z. Gazette No. 91, 30th August, 1940.]
Page 2332.

Land taken for a Native School in Block IV, Tokmanu
Survey District, subject to certain Rights and
Interests.

[L.S.] GALWAY, Governor-General.

A PROCLAMATION.

IN pursuance and exercise of the powers and author-
ities vested in me by the Public Works Act, 1928,
and of every other power and authority in anywise
enabling me in this behalf, I, George Vere Arundell,
Viscount Galway, Governor-General of the Dominion of
New Zealand, do hereby proclaim and declare that the
land described in the Schedule hereto is hereby taken
for a Native school, subject to the rights and interests
created by section fourteen of the Native Land Amend-
ment and Native Land Claims Adjustment Act, 1928;
and I do also declare that this Proclamation shall take
effect on and after the second day of September, one
thousand nine hundred and forty,

SCHEDULE.

APPROXIMATE area of the pieces of land taken: 8 acres.
Being portion of Tauranga-Taupo S8 918 Block.

Situated in Block IV, Tokmanu Survey District
(Auckland R.D.). (S.O. 30764.)

In the Auckland Land District; as the same is more
particularly delineated on the plan marked P.W.D.
10744, deposited in the office of the Minister of Public
Works at Wellington, and thereon coloured yellow.

Given under the hand of His Excellency the Governor-
General of the Dominion of New Zealand, and
issued under the Seal of that Dominion, this 15th
day of August, 1940.

R. SEMPLE, Minister of Public Works.

God SAVE THE KING!

(P.W. 31/1031/L)

10407

ENTRIES ENTERED IN THE REGISTER.

Native Index

THE 6th DAY OF September, 1940

AS 9.30 O'Clock.



Recorded on Taupo. Well. Map.

6/9/40

No Title

Gaz No 166207.

10407

0446207: ~~original name~~
ithin land for State Primary schools entered
18.11.1969 at £.00'c
John A. L. R.

10407
SOUTH

10407

PROCLAMATION

PARTICULARS ENTERED IN THE REGISTER
VOL. 197, PAGE 19

THE 10407 ...

[Signature]
ASST. LAND REGISTRAR
DUBLIN

uckland Land District
Aotea N.L.C. District

536

File 20/36

TAUPO COUNTY

W. J. JOHANNESSEN & CO.

This is a copy of the original plan
to which reference is made
published in No. 1111 of the
of 29-6-1900.

W. J. Johannesen
9.8.40

Lake Taupo

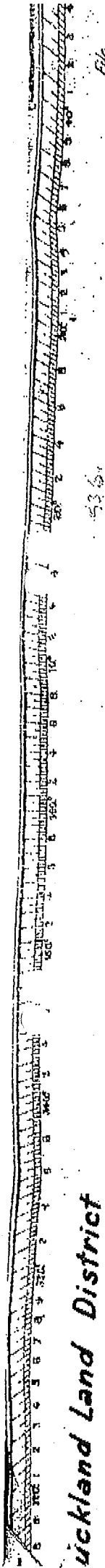
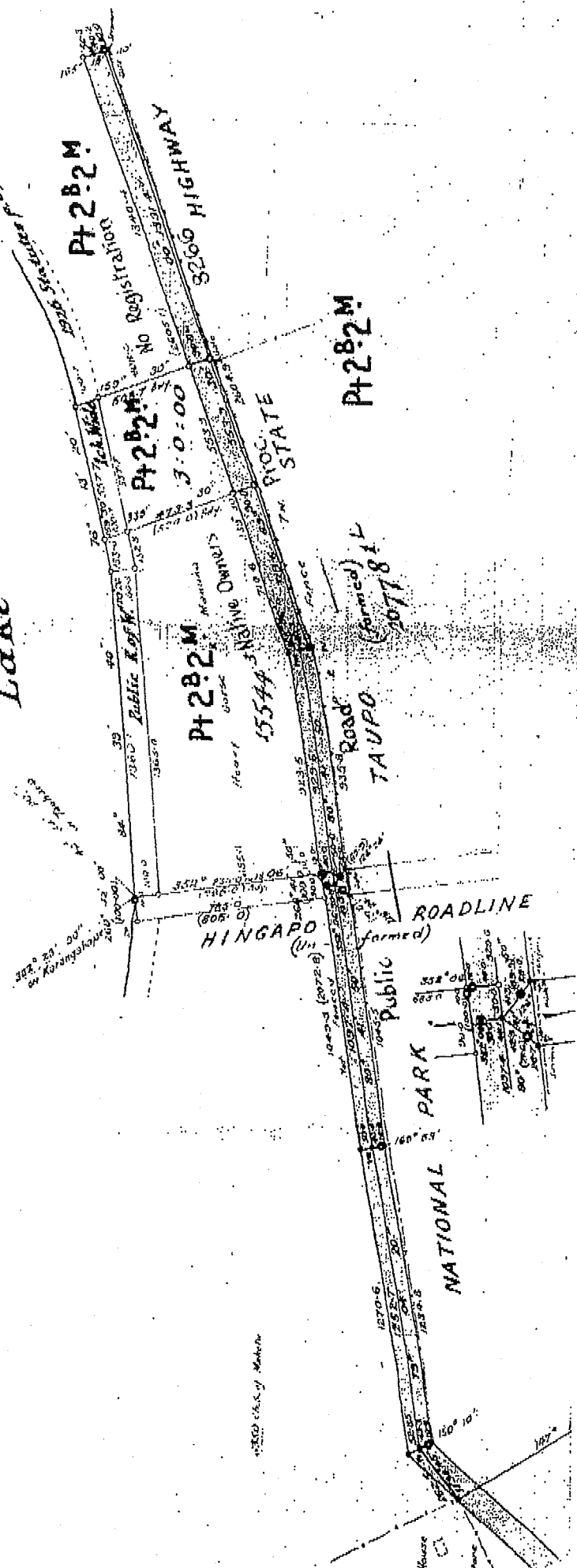

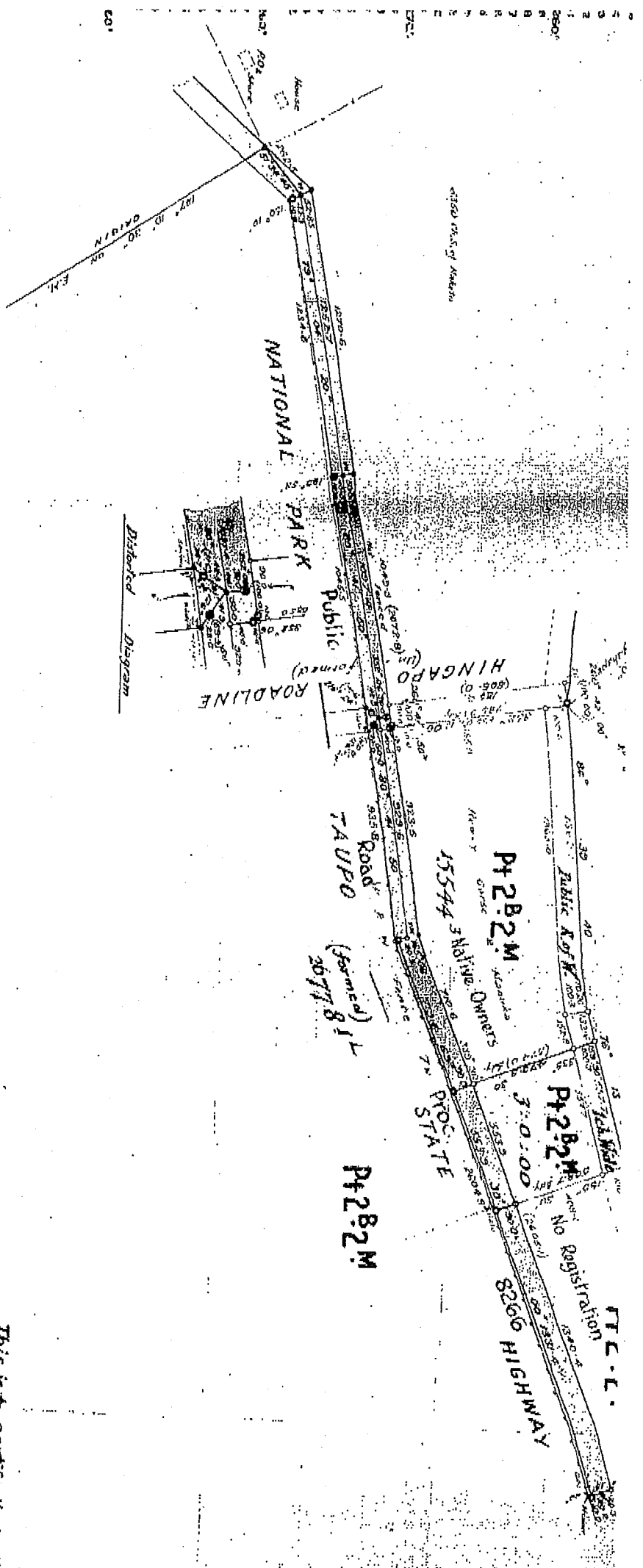

**Plan of Tauranga-Taupo Pt. 2B2M Block
to be taken for a Native School Site**

Surveyed by **E.M. Morilleau**

Registered Surveyor

Date: **Feb. 1940**

Eric Mowbray Morilleau
Auckland

Rotorua

21st Nov 1940
E. M. Morilleau

This is to certify that all the traverses have been chained & observed twice
E. M. Morilleau
Reg. Surveyor

Approved:

[Signature]

Plan No.

[Signature]

Gross Referenced
FILE: **File 20/210**
AUTHORITY: **Section 110**
PLAN: **15544 3**
REF. PLANS: **Advanced Survey**
Dated: **19-5-40**
Scale: **1:20,000**
T.B. **20,21**
Examined: **15,440**
REPRODUCTION



30764
10744

Reference:
Certificate No.

P.R. Vol. 256 Folio 9
Transfer No.
O.N.C.T. S.396817

CANCELLED



Land and Deeds 72

S REGISTER

No. 8A / 1061

CERTIFICATE OF TITLE UNDER LAND TRANSFER ACT

This Certificate dated the 7th day of February one thousand nine hundred and sixty-eight under the seal of the District Land Registrar of the Land Registration District of South Auckland being a Certificate in lieu of Grant, **WITNESSETH** that HEPI TE HEUHEU, PATERIKI HURA, BRIAN JONES, WAIREMANA

TAMAIRA, WARATANA NGAHANA, and IWA MERE HAUAUURU TUPU are

exercised of an estate in fee-simple (subject to such reservations, restrictions, encumbrances, liens, and interests as are notified by memorial underwritten or endorsed hereon) in the land hereinafter described, delineated with bold black lines on the plan hereon, be the several admeasurements a little more or less, which said land was originally acquired by TE HEHE TE HEHE and 21 others

as from the 25th day of March one thousand nine hundred and forty-two under The Native Land Act 1931. that is to say: All that parcel of land containing 7 ACRES 1 ROOD 34 PERCHES more or less being Tauranga Taupo 2B 2M 3B 3B Block



F. Jones
Assistant Land Registrar

Subject to Section 438 Maori Affairs Act 1953.

S.314630 Proclamation declaring part within land (1 acre 20 perches) to be Crown Land produced 2/6/1965 at 9.05a.m.

F. Jones
A.L.R.

F. Jones
A.L.R.

S.353199 Gazette Notice declaring land taken by S.314630 to be set apart for a Maori School produced 17/8/1966 at 9a.m.

F. Jones
A.L.R.

S.466207 Gazette Notice declaring the land taken by Proclamation S.353199 set apart for State primary schools entered 18.11.1969 at 2.00 o'clock.

F. Jones
A.L.R.

S.490171 Gazette Notice taking Lot 1 Plan S.12494 (30.3 perches) for a State Primary School entered 11.8.1970 at 12.10 o'clock.

F. Jones
A.L.R.

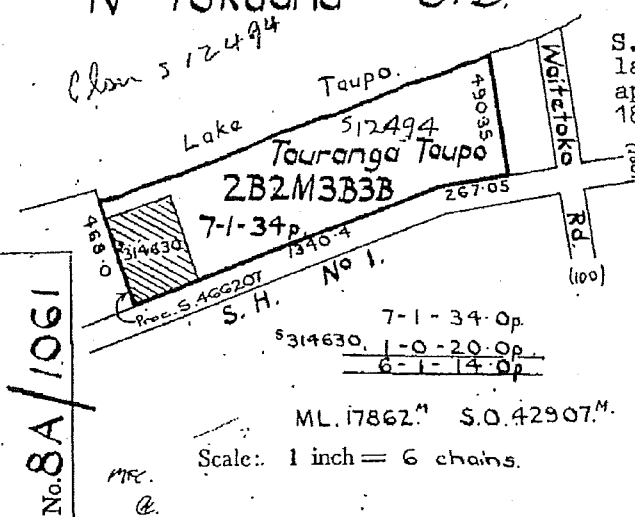

Scale: 1 inch = 6 chains.

see over

No. 8A / 1061

M.R.C.
@

85/1061

Pursuant to Section 35 (4) of the Counties Amendment Act 1961 Lot 4 Plan S:12494 is vested in the Chairman, Councillors and Inhabitants of the County of Taupo as a reserve for Recreation subject to the Reserves and Domains Act 1953

12-11-1970

Pursuant to Section 35 (4) of the Counties Amendment Act 1961 Lot 5 Plan S:12494 is vested in the Chairman, Councillors and Inhabitants of the County of Taupo as a reserve for Esplanade subject to the Reserves and Domains Act 1953

12-11-1970

S.519608 Court Order cancelling Court Order S.307161 dated 23 October 1964 entered 26.5.1971 at 10.50 o'clock

S.519609 Trustee Order vesting the within land in Hepi Te Heuheu, Pateriki Hura, Brian Jones, John te Oranga Hura, Waratana Ngahana and Iwa Mere Hauaru Tupu produced 26.5.1971 at 10.50 o'clock

S.519610 (ONCT) Cancelled as to Lots 2 and 3 26.5.1971 Plan S:12494 and new O.S.T. issued

13A/144 for Lot 2 and 13A/165 for Lot 3

85/1061

S.544326 Vesting Order pursuant to Section 438 Maori Affairs Act 1953 vesting the residue of the within land in Hepi Te Heuheu, Pateriki Hura, Brian Jones, John te Oranga Hura and Waratana Ngahana produced 23.12.1971 at 2.15 o'clock

Cancelled
Defunct
10/11/71

