

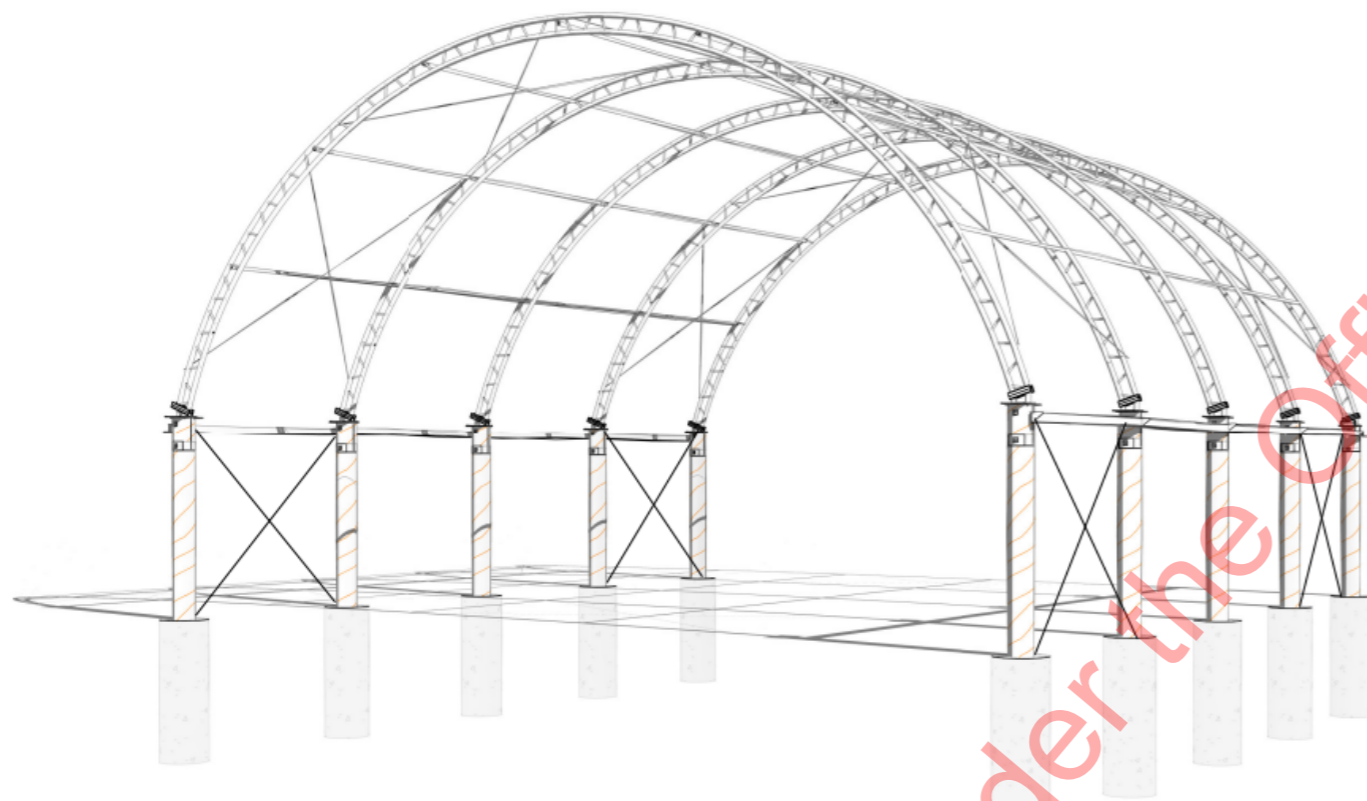

COWPOWER

SHELTER - C4040
TYPE 3 - TIMBER TO TIMBER SUPPORT
BARRY HAYES



**FENZ NELSON TEMP SHELTER, 1 GLOUCESTER
ST, NELSON**

CONCEPT

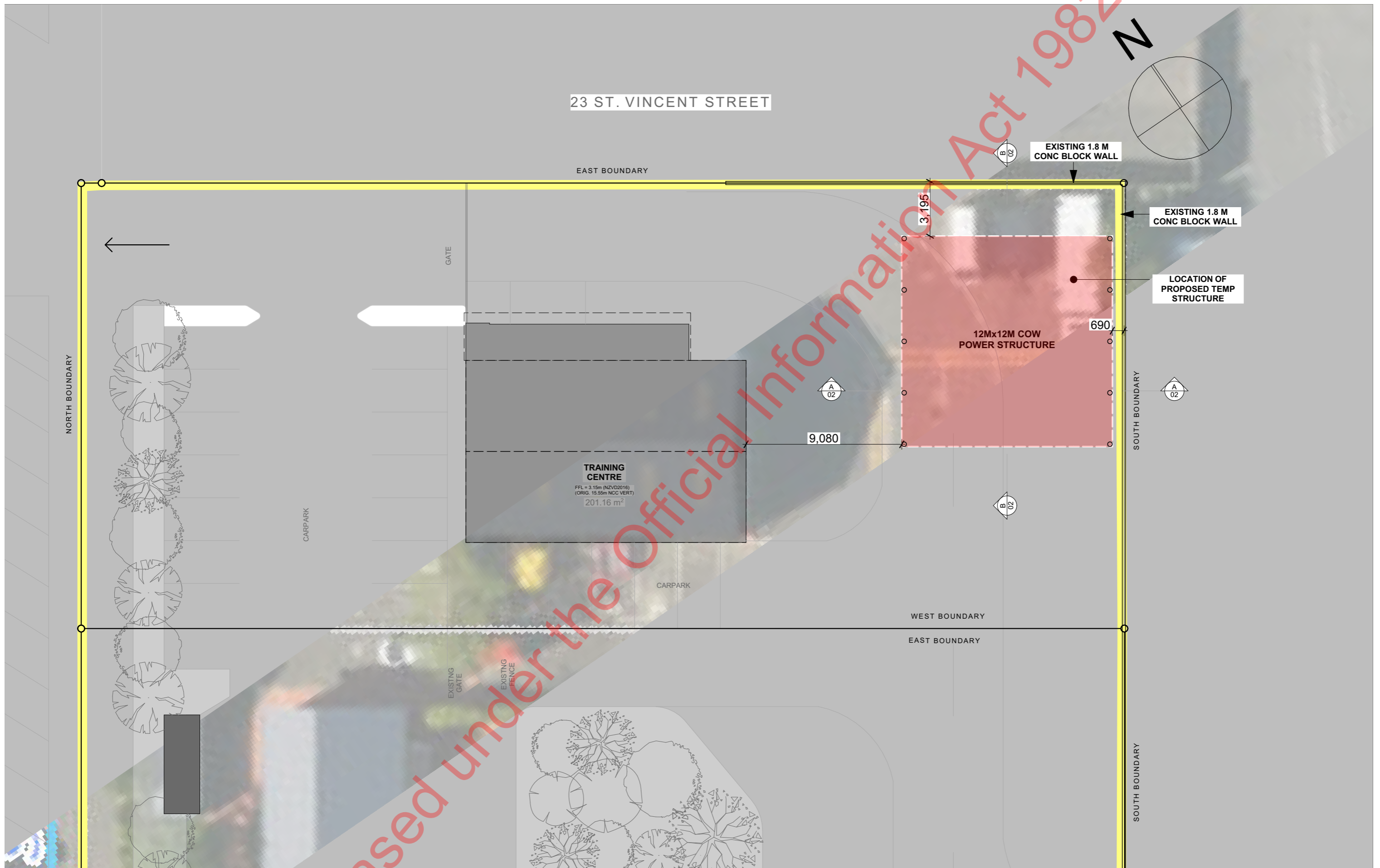

AD NZ ARCHITECTURAL DESIGNERS
FENZ NELSON TEMP SHELTER
 1 GLOUCESTER ST, NELSON
 CONCEPT

REVISION	DATE	DRAWN	NB
		DATE	13/04/2023
		JOB NO.	1108

SITE PLAN

KAD KARSTEN ARCHITECTURAL DESIGN
 P: 03-539 1066 WWW.KAD.CO.NZ

SHEET NO.	REVISION
01	

TO SCALE @ A3

CHECK ALL DIMENSIONS ON SITE. DO NOT SCALE FROM DRAWINGS. THESE DRAWINGS TO BE READ IN CONJUNCTION WITH CONSULTANTS DOCUMENTATION.

THE COPYRIGHT OF THIS DRAWING IS VESTED WITH KARSTEN ARCHITECTURAL DESIGN AND CANNOT LEGALLY BE USED, COPIED OR IN ANY WAY REPRODUCED WITHOUT WRITTEN CONSENT

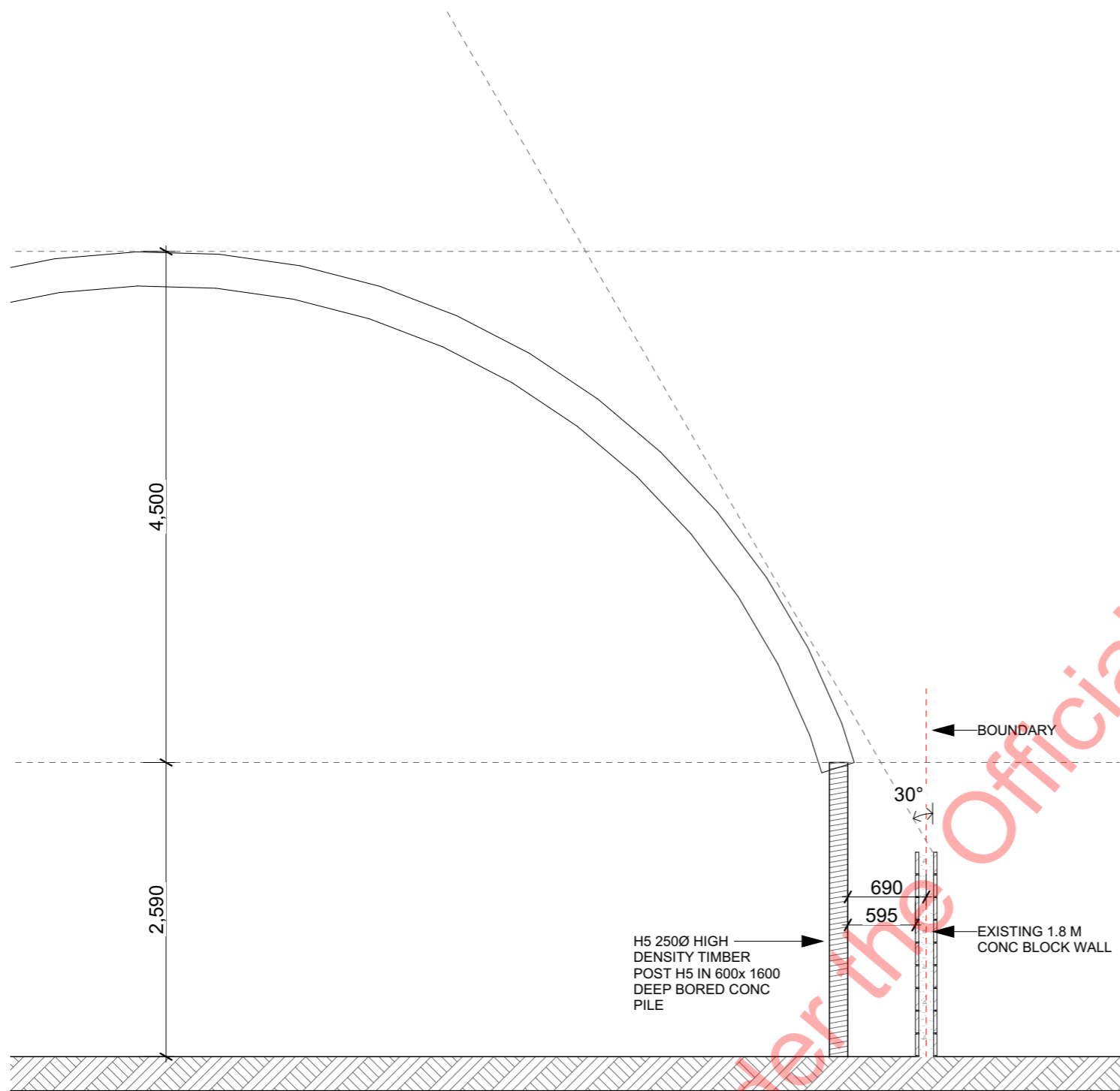

SECTION A

1:50

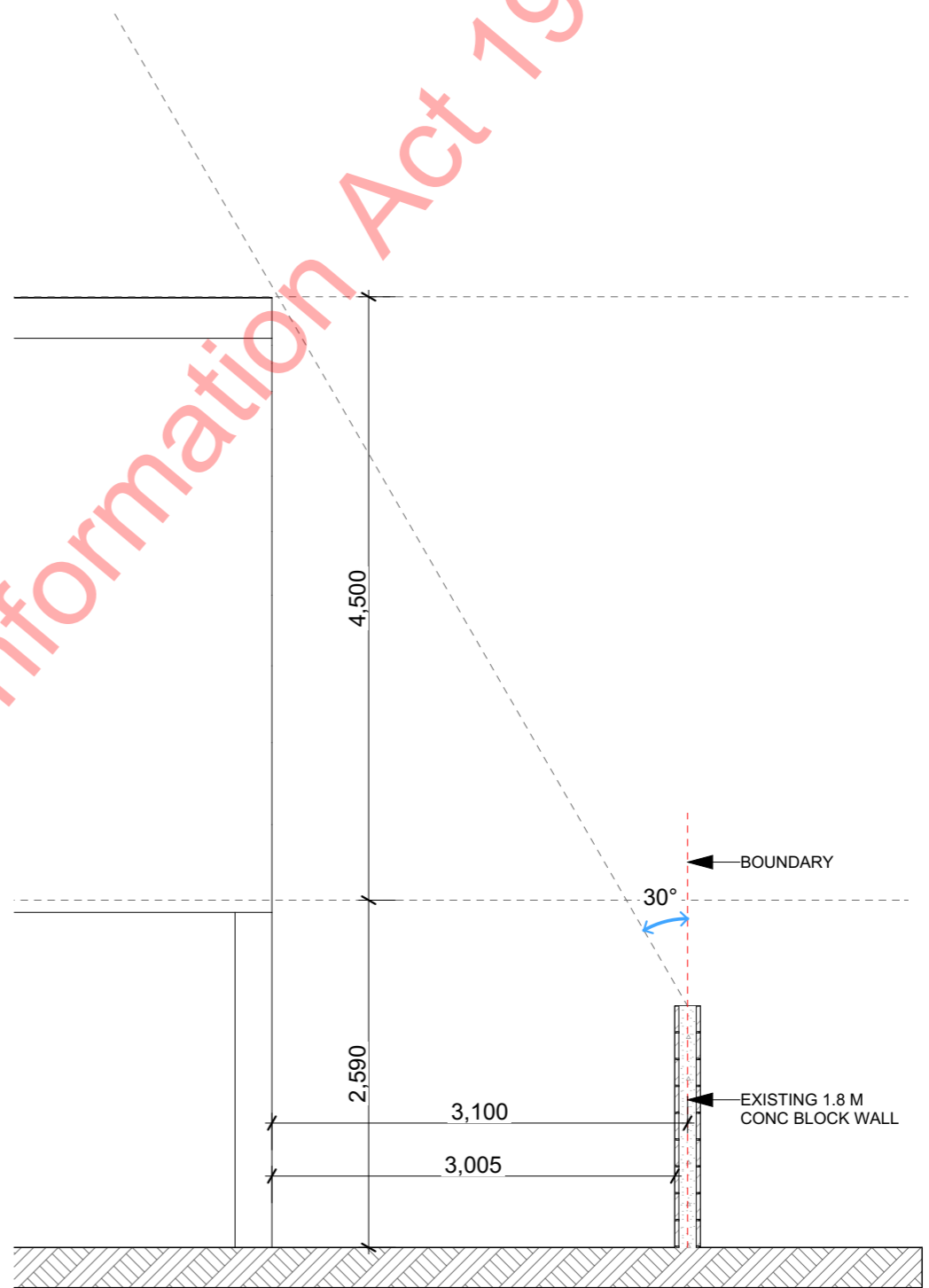

SECTION B

1:50



FENZ NELSON TEMP SHELTER
 1 GLOUCESTER ST, NELSON
 CONCEPT

REVISION	DATE	DRAWN	NB
		DATE	13/04/2023
		JOB NO.	1108

SECTIONS



KARSTEN
 ARCHITECTURAL DESIGN
 P: 03-539 1066 WWW.KAD.CO.NZ

SHEET NO.	REVISION
02	

TO SCALE @ A3
 THE COPYRIGHT OF THIS DRAWING IS VESTED WITH KARSTEN ARCHITECTURAL DESIGN AND CANNOT LEGALLY BE USED, COPIED OR IN ANY WAY REPRODUCED WITHOUT WRITTEN CONSENT

CHECK ALL DIMENSIONS ON SITE. DO NOT SCALE FROM DRAWINGS. THESE DRAWINGS TO BE READ IN CONJUNCTION WITH CONSULTANTS DOCUMENTATION.