

NEW ZEALAND.



Reference: Land Transfer (Compulsory Registration of Titles) Act, 1924.
Deeds Index. A2.61 and 288.
Application No. 27754C.

Register-book,
Vol. 593, folio 154.

CERTIFICATE OF TITLE UNDER LAND TRANSFER ACT. LIMITED AS TO PARCELS AND TITLE.

This Certificate, dated the tenth day of December, one thousand nine hundred and thirty-six under the hand and seal of the District Land Registrar of the Land Registration District of AUCKLAND Witnesseth that THE MELANESIAN MISSION TRUST BOARD a Body Corporate constituted under the Religious Charitable and Educational Trusts Act 1908

is seized of an estate in fee-simple (subject to such reservations, restrictions, encumbrances, liens, and interests as are notified by memorial under written or endorsed hereon, subject also to any existing right of the Crown to take and lay off roads under the provisions of any Act of the General Assembly of New Zealand) in the land hereinafter described, as the same is delineated by the plan hereon bordered green, be the several admeasurements a little more or less, that is to say: All ^{those} parcels of land containing together one hundred and eighty-seven acres and twenty-eight perches more or less situated in the City of Auckland being portions of Allotments 28 and 29 of the District of Tamaki.



E. W. Worthington
Assistant District Land Registrar.

Outstanding interests registered in the Deeds Register Office at Auckland:
Lease No. 283316 (R259/539) of part The Melanesian Mission Trust Board to William Henry Madill. Term 21 years from 1st February 1918.

Lease No. 375080 (R516/358) of Lease No. 283316 William Henry Madill to Glendale Farm Limited. Term commencing on 14th July 1927 and ending on 28th December 1938.

Mortgage No. 388749 (R543/516) of Lease No. 283316 William Henry Madill to the Bank of New Zealand.

Mortgage No. 388750 (R542/567) of Lease No. 375080 Glendale Farm Limited to the Bank of New Zealand.

E. W. Worthington
Asst. L.R.

This certificate of title as to parcels subject to the issue of Certificate of Title in accordance with D.P. 29673. *E. W. Worthington* 4/2/1947

Council, 13248 authorizing the laying off of "Diocata Crescent" of a width less than 66 feet but not less than 50 feet, and of an extension of a white road "an extension of Page Road, and 'Allum Street', of a width less than 66 feet but not less than 60 feet, subject to building line restrictions. 25/11/1947 at 10 am

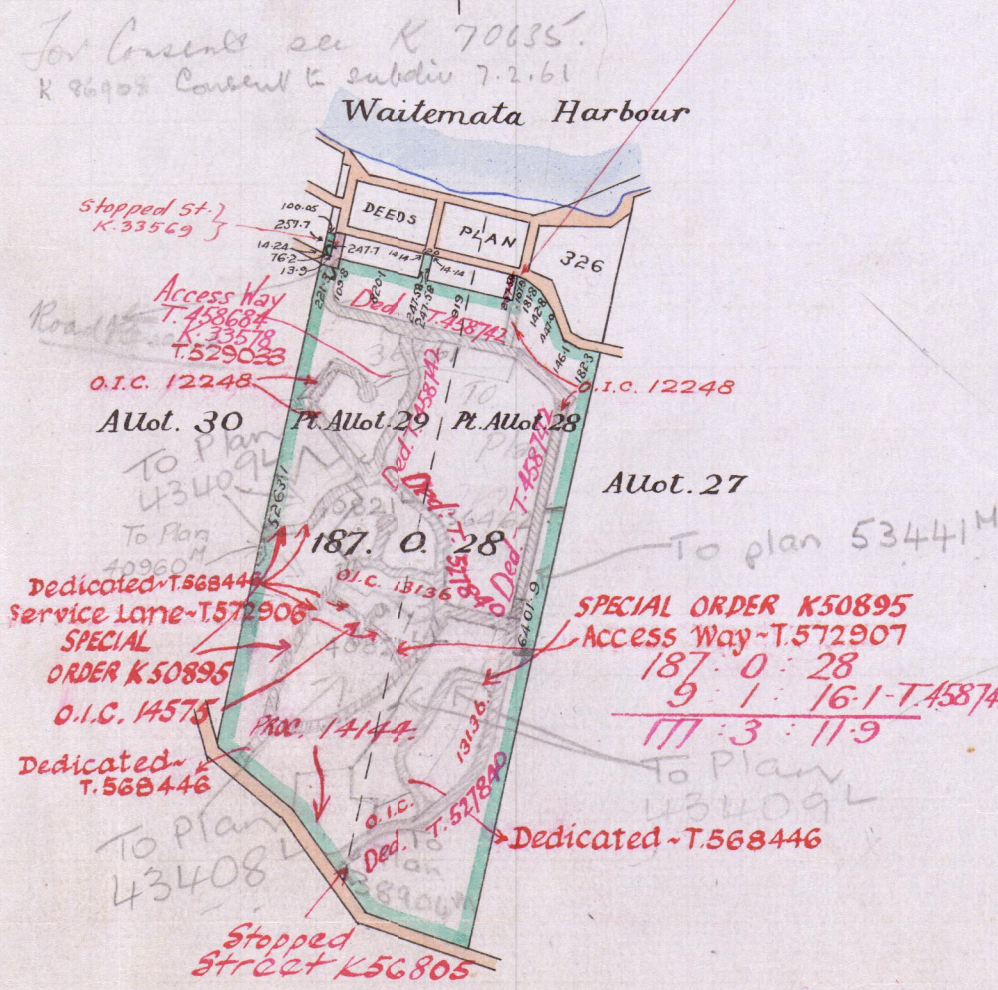
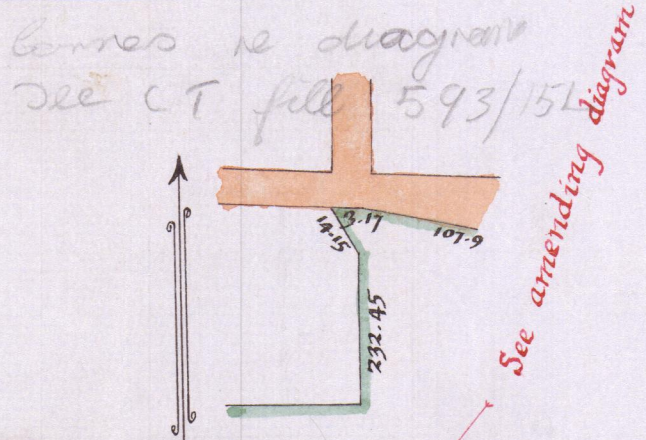

Amending diagram added
E. W. Worthington
A. L. R.
12/12/46.

Scale: 20 Chains to an Inch

Delt. L. P. L.
Th

over 5

593/154

H. 33569 Notice that the Auckland City Council has stopped part of adjoining street (Averill Avenue) containing 8.7 perches pursuant to Section 175 (4)(b) of the Municipal Corporations Act 1933 Entered 16/8/1949 at 10.50 oc.

(Cf 934/209 mind for stopped street) A.L.R.

This certificate of title has ceased to be limited as to title Entered 19.8.1949

Transfer 458684 of Lot 23 plan 36461 as and for a proposed access way. The Melanesian Mission Trust Board to the Mayor Councillors and Citizens of the City of Auckland produced 19.8.1949 at 10.30 oc.

Cuworthington A.L.R.

H.33578 Resolution by the Mayor Councillors and Citizens of the City of Auckland declaring Lot 23 plan 36461 to be an accessway. Entered 19.8.1949 at 10.32 oc.

Cuworthington A.L.R.

Transfer 458742 dedicating Lot 2 plan 36461 and Lot 152 plan 36462 as public streets produced 19.8.1949 at 2.15 oc.

Cuworthington A.L.R.

By virtue of Section 332 (9) Municipal Corporations Act 1933 Lot 115 (Drainage Reserve) Lots 129, 146 (Road Reserves) plan 36462 are vested in the Mayor Councillors and Citizens of the City of Auckland.

Cuworthington A.L.R.

Lease 21417 of Lot 1 plan 36461 The Board above named to Leo Ignatius Bell. Term 21 years from 12.5.1949. Produced 24.8.1949 at 10.30 oc.

With provision from 1.9.1949 A.L.R.

Lease 21426 of Lot 180 plan 36461 The Board above named to Esther Riggkin. Term 21 years from 12.5.1949 Produced 24.8.1949 at 10.39 oc.

A.L.R.

Cancelled and new b.s. issued as to Lots. 34 = 936/183 Lot 39 = 936/184 Lot 66 = 936/185 Lot 68 = 936/186 Lot 80 = 936/187 Lot 91 = 936/188 Lot 100 = 936/189 plan 36461 and Lot 135 = 936/190 Lot 159 = 936/191 Lot 173 = 936/192 Lot 175 = 936/193 Lot 177 = 936/194 plan 36462 Lot 182 = 936/195 plan 36462. wawilson A.L.R.

Cancelled as to Lot 58 plan 36461 and new b.s. issued Vol 936 Fol 196. wawilson A.L.R.

Cancelled as to Lot 97 plan 2.9.1949 36461 and b.s. issued Vol 936 Fol 197 wawilson A.L.R.

Transfer 460391 Grant of Storm Water Drainage Rights over the part of lots 1, 3, 4, 5 coloured blue, the part of lots 25, 26 hatched blue, the part of lots 27, 50 coloured blue, the part of lot 27 hatched blue, the part of Lot 28 coloured blue and the part of Lots 51, 52, 53, 54, 55 and 56 coloured blue on plan 36461 and the parts of Lots 116, 117 coloured blue, the part Lot 117 hatched blue and the parts of Lots 136, 169, 170 coloured blue on plan 36462. The Board above named to the Mayor Councillors and Citizens of the City of Auckland produced 16.9.1949 at 2.40 oc.

wawilson A.L.R.

Cancelled and new b.s. issued as to: Lot 118 plan 36462 938/152 Lot 117 " " 938/153 Lot 116 " " 938/152 wawilson A.L.R.

Cancelled as to Lot 183 plan 28/9/1949 36461 and new C.T. issued Vol 939 Folio 121 Benjamin A.L.R.

Cancelled as to Lot 180 plan 36462 & new C.T. issued Vol 939 Fol 366. Benjamin A.L.R.

Cancelled as to Lots as tabulated & C.T. issued 21/10/1949 Benjamin A.L.R.

	lot Plan C.T.	lot Plan C.T.	lot Plan C.T.
3	36461 941/119 82	36461 941/143 127	36462 941/167
6	" 129 84	" 144 131	" 168
8	" 121 86	" 145 134	" 169
9	" 122 90	" 146 137	" 170
11	" 123 92	" 147 141	" 171
12	" 124 93	" 148 143	" 172
13	" 125 94	" 149 144	" 173
21	" 126 98	" 150 147	" 174
29	" 127 99	" 151 150	" 175
31	" 128 102	" 152 154	" 176
33	" 129 103	" 153 157	" 177
41	" 130 104	" 154 161	" 178
42	" 131 105	" 155 162	" 179
44	" 132 107	" 156 163	" 180
47	" 133 109	" 157 165	" 181
55	" 134 105	36462 158 166	" 182
56	" 135 106	" 159 172	" 183
60	" 136 110	" 160 174	" 184
63	" 137 112	" 161 179	" 185
69	" 138 113	" 162	" 186
71	" 139 119	" 163	" 187
72	" 140 120	" 164	" 188
79	" 141 121	" 165	" 189
81	" 142 122	" 166	" 190

see end of volume

Benjamin A.L.R. 13,000/5/36-1781

593/154

593/154

Continued.

The part lots 124+125 coloured yellow on plan 36462 herein are subject to a right of way appurtenant to lot 120 plan 36462 CT. 941/164 created by Lease 21534.

term 21 years from 12/5/1949 W Benjamin P.R. 21/10/1949

The part lots 124+125 coloured yellow on plan 36462 herein are subject to a right of way appurtenant to lot 119 plan 36462 CT. 941/163 created by Lease 21535 term

21 years from 12/5/1949 W Benjamin P.R. 21/10/1949

C. 26513. } Cancelled as to the lots as
28/10/1949 } tabulated and new C's issued.

lot	Plan	New CT.	lot	Plan	New CT.
25	36461	941/265	73	36461	941/282
24	"	266	88	"	283
4	"	267	96	"	284
7	"	268	190	"	285
10	"	269	197	"	286
30	"	270	124	36462	287
35	"	271	109	"	288
36	"	272	123	"	289
38	"	273	126	"	290
40	"	274	139	"	291
50	"	275	145	"	292
53	"	276	148	"	293
57	"	277	158	"	294
59	"	278	164	"	295
62	"	279	170	"	296
64	"	280	176	"	297
65	"	281	181	"	298

W Benjamin

The part lot 125 coloured yellow on plan 36462 herein is subject to a right of way appurtenant to lot 124 plan 36462 CT. 941/287 created by Lease 21602 term

21 years from 12/5/1949 W Benjamin P.R. 28/10/1949

The part lots 26+27 coloured yellow on plan 36461 herein is subject to a right of way appurtenant to lot 24 plan 36461 CT. 941/266 created by Lease 21603 term

21 years from 12/5/1949 W Benjamin P.R. 28/10/1949

The part lots 26+27 coloured yellow on plan 36461 herein is subject to a right of way appurtenant to lot 25 plan 36461 CT. 941/265 created by Lease 21604 term

21 years from 12/5/1949 W Benjamin P.R. 28/10/1949

C. 26549 } Cancelled as to lot 1 plan
8/11/1949 } 36461 and new CT. issued
Vol. 943 Fol. 146

C. 26582 } Cancelled as to lots as tabulated
16/11/1949 } and new CT's issued:-

lot	new CT.	lot	new CT.
lot 22	new CT. 943/264	lot 111	943/243
plan 36461	32 943/265	plan 36462	114 274
	43 266		130 275
	45 267		138 276
	49 268		142 277
	61 269		168 278
	40 270		167 279
	83 271		167 279

C.	Date	Cancelled as to	new C's issued:-
C. 26677	6/12/1949	lot 106 as tabulated	lot Plan Reference Lot Plan Reference
			5 36461 947/284 104 36462 947/2
			37 " 285 108 " 29
			46 " 286 133 " 29
			48 " 287 140 " 29
			52 " 288 149 " 29
			54 " 289 151 " 30
			67 " 290 169 " 950
			78 " 291 171 " 950
			95 " 292
			186 " 293
			191 " 294

593/154

Ch. E. Santinidge A.L.R.

C. 26682 } Cancelled as to lot 87 plan
6/12/1949 } 36461 and CT. issued Vol. 950 Fol. 17

Ch. E. Santinidge A.L.R.

Appurtenant to lot 125 plan 36462 herein is a right of way over the part lot 124 shown coloured yellow on said plan 36462. (CT. 941/287) created by lease 21602 term 21 years from 12/5/1949. W Benjamin P.R. 28/10/1949

C. 26682 } Cancelled as to lot 87 plan
6/12/1949 } 36461 and new certificate of Title Vol. 950 Fol. 17 issued.

Ch. E. Santinidge

C. 26869. } Cancelled as to lots as tabulated
15/2/50 } & new CT. issued:-

lot 14	plan 36461	952/235
lot 15	"	236
lot 16	"	237
lot 17	"	238
lot 18	"	239
lot 19	"	240

C. 26840 } Cancelled as to lots as tabulated
15/2/50 } & new CT. issued:-

lot 51	plan 36461	952/241
" 85	"	242
" 184	"	243
lot 132	" 36462	
" 156	"	
" 160	"	

C. 26849 } Cancelled as to lot 1
16/2/50 } CT. issued:-

lot 188	plan 36461	
lot 136	" 36461	

C. 26919 } Cancelled as to lot 1
1/3/1950 } new C's issued:-

lot 192	plan 36461	
" 193	"	
" 194	"	
" 195	"	
" 196	"	

C. 26936 } Cancelled as to lot 1
9.3.1950 } new C.T. issued

(4)

b.26841 { cancelled as to lots below
7/2/1950 and new lot T issued:
Lot 26 op 36461 952/129
" 27 " " " 131
" 28 " " " 130

Eunworthington

b.24007 { cancelled as to Lot 155 plan
23-3-1950 36462 and new CT issued
Vol. 954 Folio. 263.

b.27119 { cancelled as to lot 20 plan
5-5-1950 36461 and new CT issued
Vol. 961 Folio. 147.

Eunworthington

Order in Council 13136 authorizing the laying
off of a proposed street (Lalage Place) at a
width for part of its length of less than 66 feet
but not less than 45 feet, of a proposed street
(Spout Road) (portion) at a width for part
of its length of less than 66 feet but not less
than 54 feet and of the proposed street (extension
of Allam Street) at a width for part of its
length of less than 66 feet but not less than
60 feet all being subject to a building line
condition - Entered 26-1-1951 at 2 pm
GAZ. 1950 P. 2071

Eunworthington

C. 28080 Withdrawn from registration
19.7.1951

This C.T. has ceased to be limited as to
part subject to the issue of a new C.T.
In accord with D.P. 3890/1
5.11.51

C.28843 { cancelled as to lots 1, 2, 3, 4, 5, 6, 7,
29.2.52. 8, 9, 10, 11, 12, 13, 14 & 15 plan 38904 and
new C.T. issued Vol. 1025 fol. 218.

W. Benjamin A.R.

Transfer 527840 dedicating part as public
street. Produced 5-8-1953 at 11.45.0c.

W. Benjamin A.R.

Transfer 529033 of Lot 4 Plan 40821 The Melanesian
Mission Trust Board to the Mayor Councillors
and Citizens of the City of Auckland as and
Produced 27.8.1953 at 11.45.0c.

W. Benjamin A.R.

This C.T. has ceased to be limited as to
subject to the issue of a new C.T.
40821
27.8.53

40822
27.8.1953

b.30733 { cancelled as to land on plan 40821
16-10-1953 and new B.J. issued: - Vol 1087 fol. 265

W. Benjamin A.R.

b.30734 { cancelled as to land on plan 40822
16-10-1953 and new B.J. issued: - Vol 1087 fol. 266

W. Benjamin A.R.

X 18280 caveat against part lot 3 pp. 29673
(7 acres 29.3 perches) by Her Majesty the
Queen entered 23.3.1954 at 10.50

Proclamation 4144 taking part lot 3
pp. 29673 (7 acres 29.3 perches) for a
public school entered 6.4.1954 at 10.00

Transfer 543002 of ^{the part} lots 2 and 3 plan
40960 The Melanesian Mission
Trust Board to Kenneth Edward
Corbett and Mildred Mand
Carruthers, produced 23/6/1954 at
2.00

1114/58, 59. A.L.R.
K50895 Special Order authorizing the
laying off of underwidth streets, subject
to a building-line restriction Entered
19/7/1954 at 10.00

Order in Council 14575 A.L.R.
(GODFREY PLACE)
underwidth restriction to a building
line restriction. 4/7 55. at 2.45.0c

Transfer 568446 dedicating parts as public streets
Produced 22-12-1955 at 12.0c

C33804 { cancelled as to lots 1 to 40 inclusive
23/2/1956 and lot 198 Plan 43407 and new C.T.
issued Vol. 1190 fol 44

W. Benjamin A.R.

C33806 { cancelled as to lots 54 to 65
23/2/1956 inclusive, 95 to 112 inclusive
135 to 154 inclusive, 188 and 189
Plan 43408 and new C.T. issued
Vol 1190 fol 45

W. Benjamin A.R.

C33807 { cancelled as to the land on Plan 43409
23/2/1956 and new C.T. issued
Vol 1190 fol 46

W. Benjamin A.R.

C33810 { cancelled as to lots 41 to 53 inclusive
23/2/1956 66 to 94 inclusive, 113 to 134 inclusive
and lot 197 Plan 43408 and new C.T.
issued. Vol 1190 fol 47

W. Benjamin A.R.

~~Transfer 572906 dedicating Lot 193 Plan 13408 as a service lane, produced 8.5.1956 at 2.460%~~

A.L.R.

Transfer 572906 of Lot 193 plan 13408 to the Mayor Councillors and Citizens of the City of Auckland as an access way produced 8.5.1956 at 2.460%

W. Brennan A.R.

Transfer 572907 of Lot 194 plan 13408 to the Mayor Councillors and Citizens of the City of Auckland as a service lane - produced 8.5.1956 at 2.440%

W. Brennan A.R.

Transfer 625024 of Lots 76 and 89 and Lot 178 Plan 36462 to the Mayor Councillors and Citizens of the City of Auckland as a reserve for recreation purposes under the Reserve Land Disposal Act 1953. Produced 5.8.1959 at 11.00%

1663/92.

J. Vermeir A.R.

Lease 25510 of Lot 23 Plan 36462 to Vincent Britain for 21 years from 11.8.1959 (containing and renewal clauses) Produced 11.8.1959 at 10.350%

Handwritten notes: MERLOT 23, 28, 29, 30, 31, 32, 33, 34, 35, 36, 37, 38, 39, 40, 41, 42, 43, 44, 45, 46, 47, 48, 49, 50, 51, 52, 53, 54, 55, 56, 57, 58, 59, 60, 61, 62, 63, 64, 65, 66, 67, 68, 69, 70, 71, 72, 73, 74, 75, 76, 77, 78, 79, 80, 81, 82, 83, 84, 85, 86, 87, 88, 89, 90, 91, 92, 93, 94, 95, 96, 97, 98, 99, 100. See A.R.

Malcolmson A.R.

Lease 25511 of Lot 74 Plan 36461 to Alan William Cunliffe. Term 21 years from 24.6.1959 (containing and renewal clauses). Produced 11.8.1959 at 10.350%.

Malcolmson A.R.

Mortgage 507107 of Lease 25510 to The National Mutual Life Association of Australasia Limited produced 13.7.1961 at 12.190%

J. Smith A.R.

193294 the leasehold interest under lease 25510 is set out as a joint family home under The Joint Family Home Act 1956 on Frederick Vincent Britain abovenamed and Freda Margaret Britain his wife in whom the whole land is now vested as joint tenants subject to the said Act. Entered 14.8.1961 at 9.47%

Flourens A.R.

Transfer 667952 of part to Jack Herbert Andrews and Dorothy Mary Andrews. Produced 24.9.1961 at 9.460%

1978/12.

Malcolmson A.R.

Lease 33345 of Lot 77 Plan 36461 to Clement Kevin Brady. Term 21 years from 10.2.1964 (containing and renewal clauses) Produced 10.3.1964 at 12.120%

W. Brennan A.R.

19534 Transfer of Lot 1 Plan 53441 (the residue) to James Inglis Limited and Christopher Lewis Limited as tenants in common in equal shares produced 14/7/1964 at 10.00%

4A/643

W. Brennan A.R.

~~Cancelled~~

A80270. Transfer of Lease 33345 to Sections Developments Limited. produced 2.6.1965 at 11.190%

W. Brennan A.R.

A.102385 Transfer of Lot 128 Plan 36462 to Frederick Vincent Brittain and Freda Margaret Brittain. Produced 8-9-1965 at 2.440%

TA/63

W. Brennan A.R.

A225839 Transfer of lease 21839 to Francis Adolph Bruce of Auckland - 26.6.1967 at 11.250%

A.L.R.

~~A213143~~ ~~Caused by the New Zealand Investment Mortgage + Deposit Company limited 20-3-1968 at 2.50%~~

Req. A.R.

Entered in Error.

A.402726 Transmission of the interest of Arthur William McHeish in Lease 21439 to Geraldine May McHeish as survivor 15.7.1969 at 2.150%

W. Brennan A.R.

CLOSED FOR MEMORIALS see new loose leaf copy

593/154